

INSPECTION

1. Left Side:  
INSPECT MIRROR CONTROL SWITCH CONTINUITY

Tester connection	Switch position	Specified condition
-	OFF	No continuity
1 - 9	UP	Continuity
6 - 10		
1 - 10	DOWN	Continuity
6 - 9		
5 - 9	LEFT	Continuity
6 - 10		
5 - 10	RIGHT	Continuity
6 - 9		

2. Right Side:  
INSPECT MIRROR CONTROL SWITCH CONTINUITY

Tester connection	Switch position	Specified condition
-	OFF	No continuity
6 - 10	UP	Continuity
7 - 9		
6 - 9	DOWN	Continuity
7 - 10		
6 - 10	LEFT	Continuity
8 - 9		
6 - 9	RIGHT	Continuity
8 - 10		

If the continuity is not as specified, replace the switch.

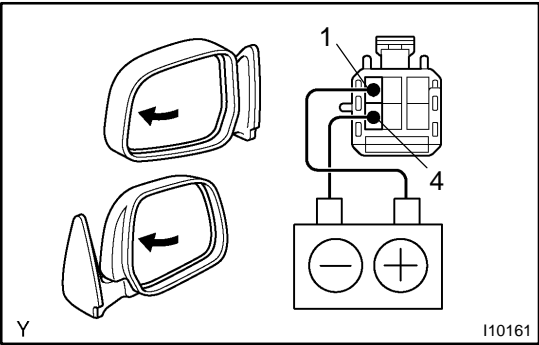

3. INSPECT MIRROR MOTOR

- (a) Connect the positive (+) lead from the battery to terminal 1 and negative (-) lead to terminal 4, then check that the mirror turns left.

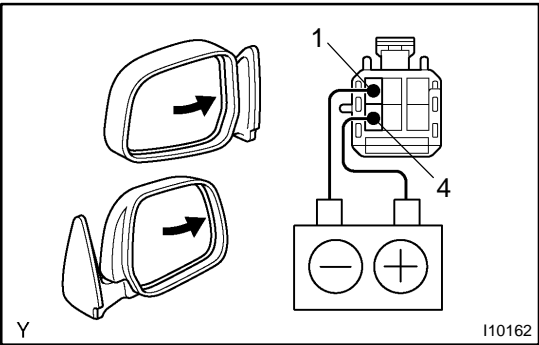

- (b) Reverse the polarity, check that the mirror turns right.

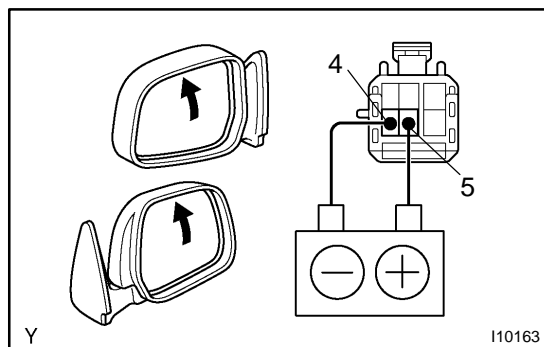

- (c) Connect the positive (+) lead from the battery to terminal 5 and the negative (-) lead to terminal 4, check that the mirror turns upward.

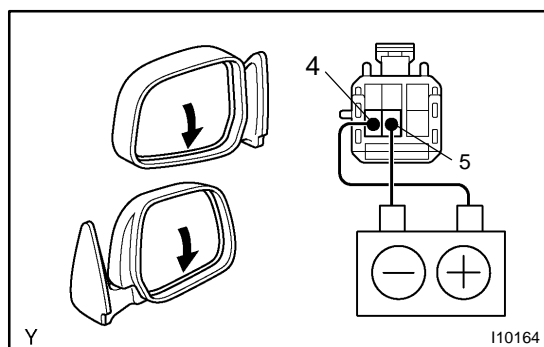

- (d) Reverse the polarity, check that the mirror turns downward.  
If the operation is not as specified, replace the mirror assembly.